

# PHI



Module B - Programming Pronto(Pro) NG  
without the PC

# Take-away

- Know how to operate the Pronto with its default configuration
- Know how to adapt the default configuration without using the PC

# Contents

- General navigation
- Setting up IR codes
- Adapting / creating a macro
- Other tools

# PHI

## General navigation



# Switching devices

## 1. Use the device menu



# Switching devices - ctd

## 2. Use the buttons on the top

- Left: previous device
- Right: next device





# Switching pages

## 1. Use the hardbuttons on the side

Backlight

Page up

Page down

- Note: hold backlight + page up / down arranges the contrast or brightness



# Switching pages - ctd

## 2. The page menu

- Direct access to all pages of a device
- Access by pressing the page numbers indication

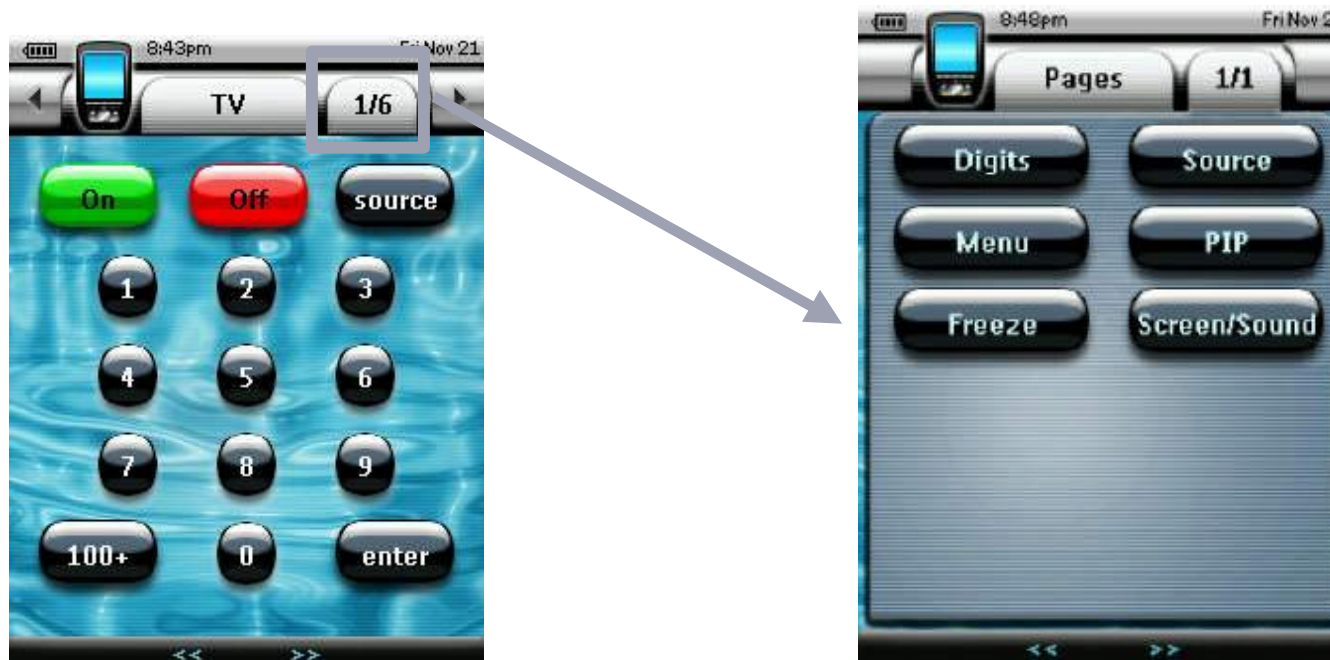



# Navigating to the Tools / Settings

- Accessing the Tools:  
Press and hold  for 3 seconds



- Exit the Tools:  
Press 

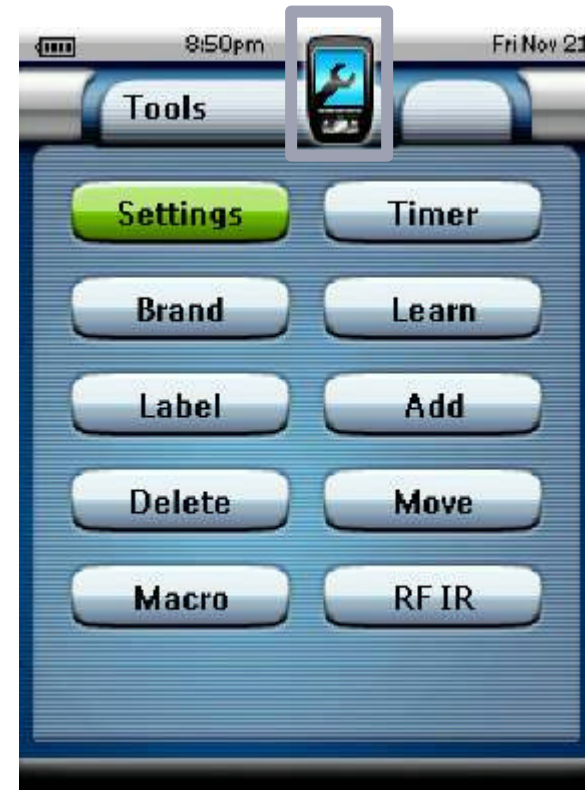

# Changing the settings - ctd



- Change by selecting and using the

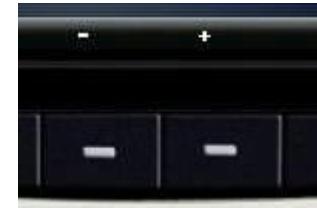

- Battery level indication
- Clock settings:
  - 24, AM/PM, no time
  - Date: Day automatically
- LCD Timeout:
  - from 3 to 240 sec.
- Brightness
  - 4 settings
  - More bright => more power  
=> sooner empty battery
- Sound volumes (toggles):
  - LCD
  - Button





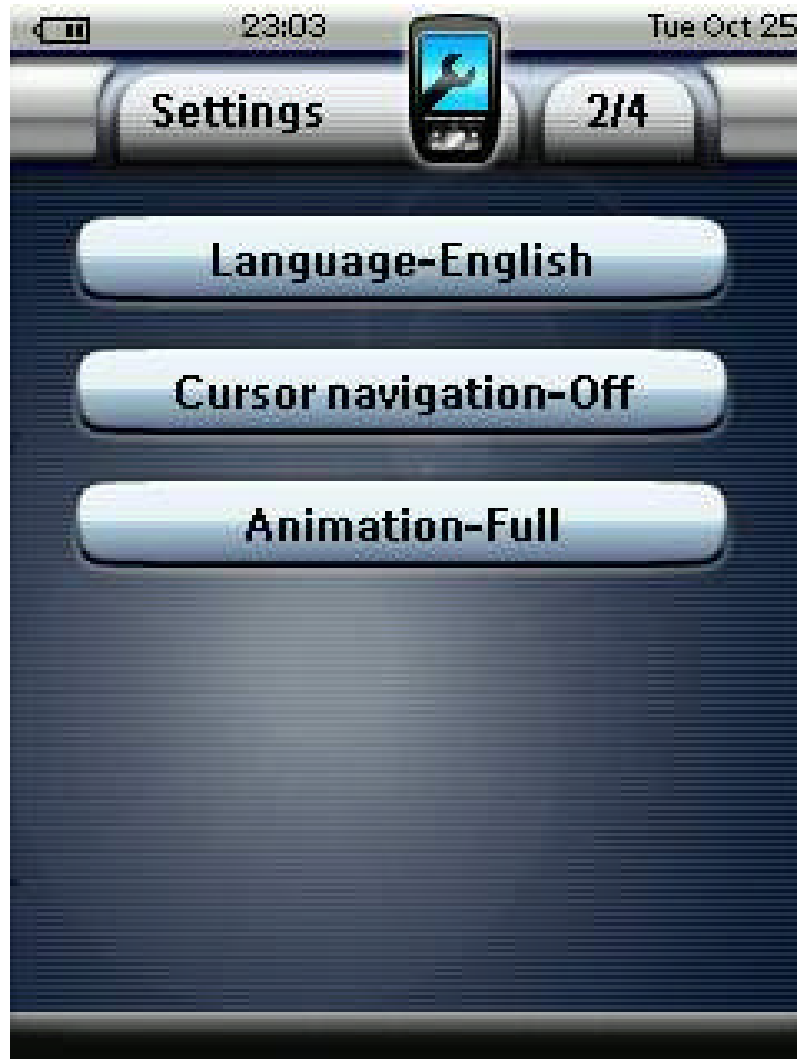

# Changing the settings - ctd

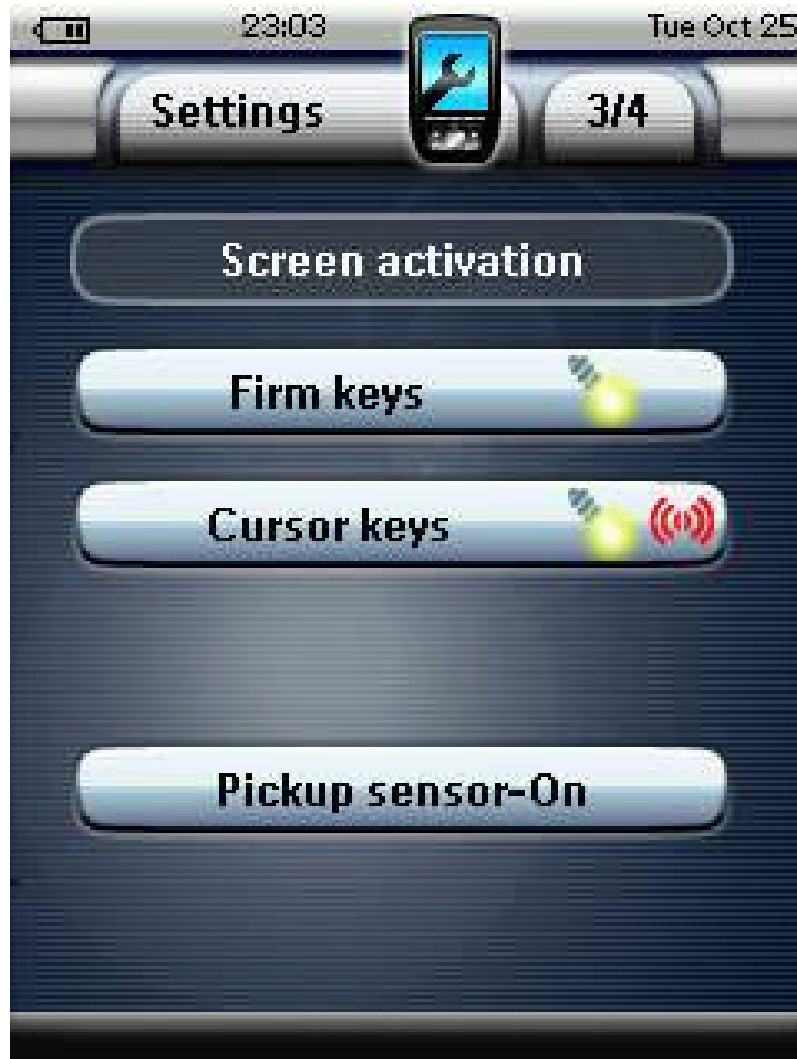

- Language
  - English
  - German
  - French
  - Dutch
  - Spanish
- Cursor navigation on/off
- Animation:
  - Full
  - Page (menu) only
  - Mode (menu) only
  - None

# Changing the settings: Screen Activation rules



- Firm keys: keys below LCD screen:
- Cursor keys
- Settings:
  - Activate screen only 
  - Send out IR, but do not activate the screen 
  - Activate the screen and send out IR 
- Pickup sensor:
  - On / Off

# Changing the settings - ctd

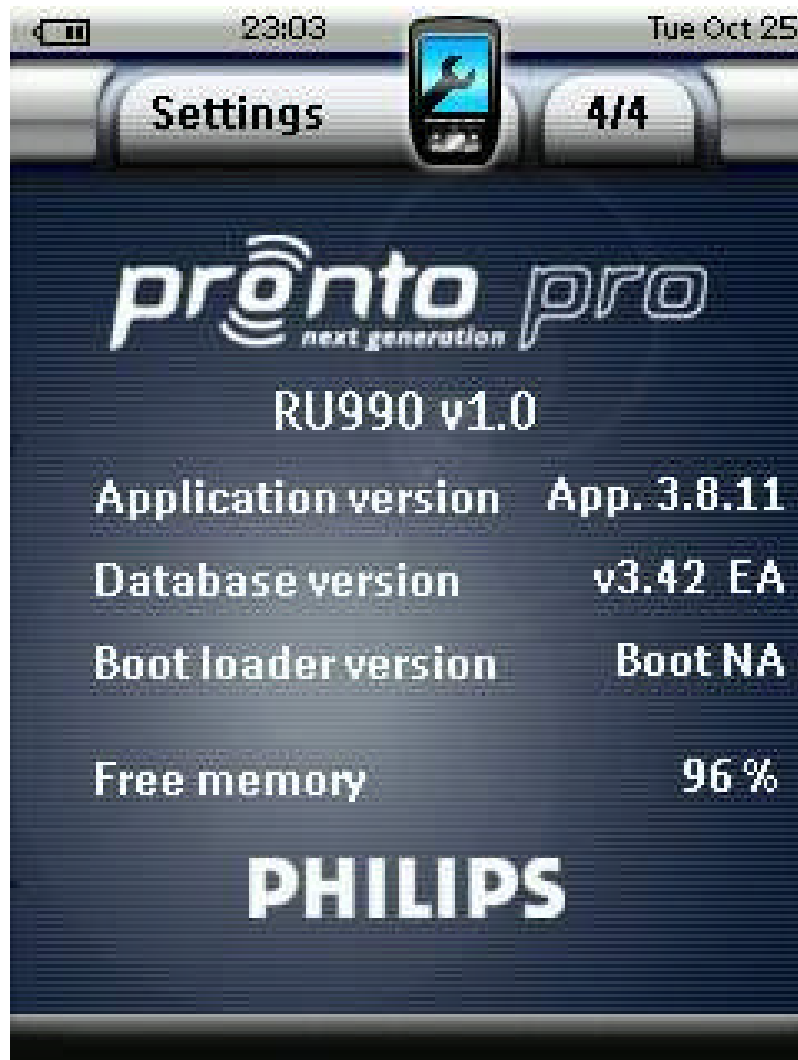

- Versions of the system
  - Application: can be changed with firmware updates
  - Boot loader version: specifies product
  - Database version: can not be changed
- Free memory in %

# Cursor navigation: the cursor

- The cursor is normally used for IR control
- When activated in the device menu, you can also set it to navigate the ProntoPro

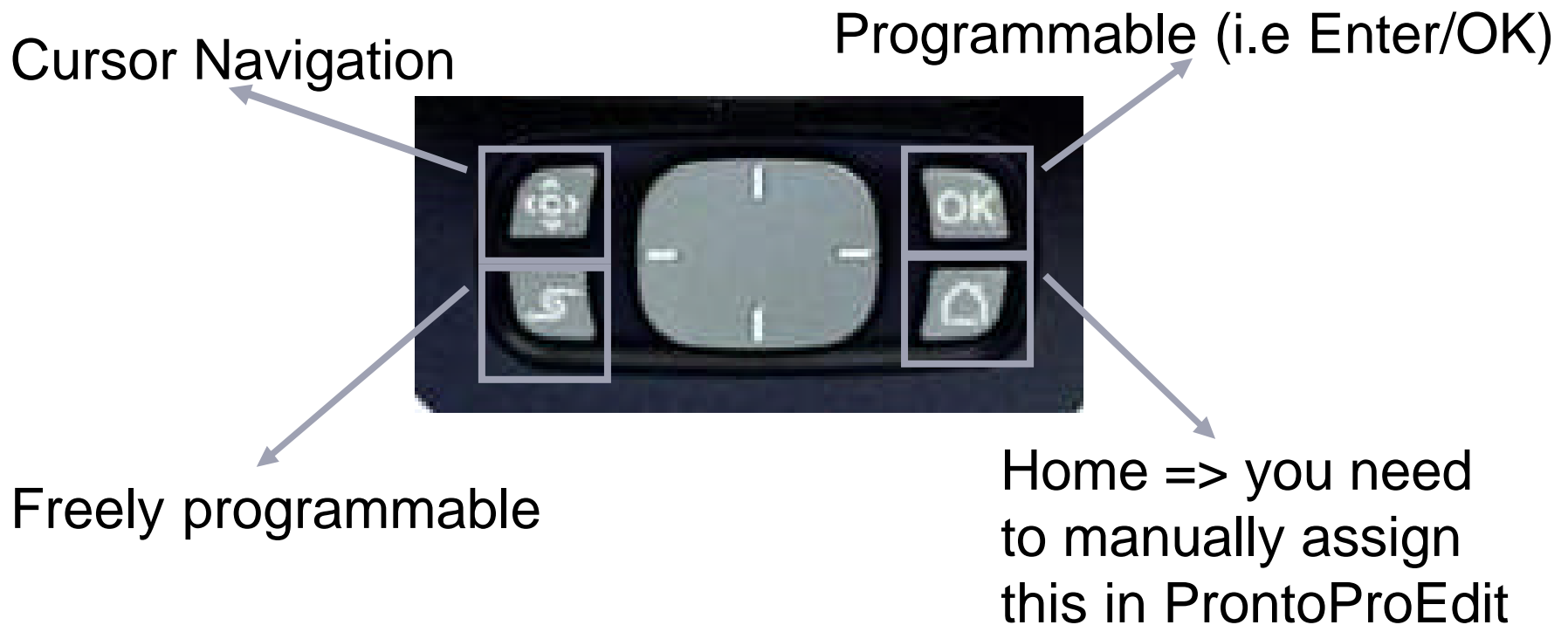



# Cursor navigation - ctd

- Enable in the settings menu (see later)
- To use the cursor for navigation press
- Top system will change if enabled

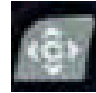

- Use cursor left / right for next / previous device
  - Use cursor up / down for next / previous page
  - To use cursor for IR control press
- 
- Press the button again, the system will change back to original

# PHI

## Setting up IR codes



# Steps to take

1. Use the Brand tool to select the correct brand + codeset
2. Learn functions that do not work

# Brand - tool

- Functions:
  - Manually select a codeset for a brand  
(= a group of related codes)
  - Autosearch on all codesets for a brand
  - Autosearch on all codesets for a specific device

# Brand – tool - ctd



Select a device for which you want to change the brand.

# Brand – tool - ctd

Only in case there are more code sets



Your current selection is listed

Search will perform a search on the **whole** database for the selected device

Your current selection is listed

Search will perform a search on the **selected brand** for the selected device



# Brand – tool - ctd

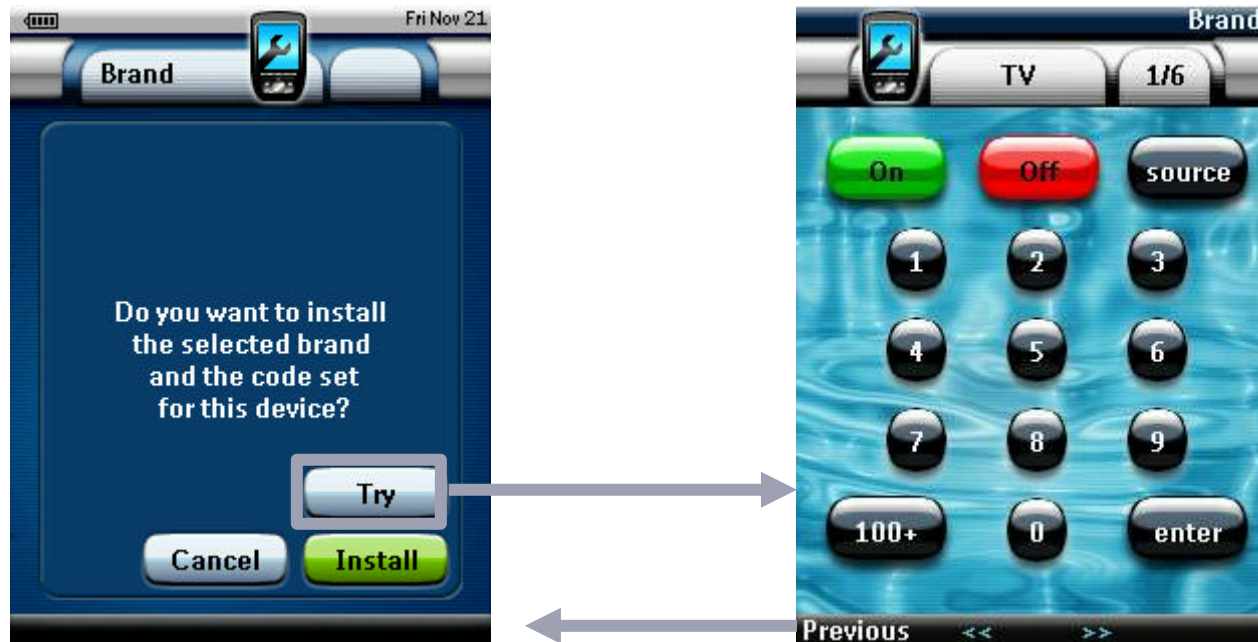

You can tryout the selected codeset. Then press “Previous” to go back

# Brand – tool - ctd

- Search mode:



- No indication which code set is selected
- When you press cancel, you don't have the option to continue searching

# Learn - tool

- Functions:
  - Learn all buttons for a device one by one
- You can not learn:
  - Backlight key
  - Left firmkey
  - Cursor key when in cursor navigation mode

# Learn – tool: tips for better learning

- IR = light → light sources interfere. Especially:
  - Fluorescent lights
  - Halogen spots
  - Bright sunlight
- Advice:
  - Try to learn in a dark room or underneath a box
- When to press the original button?
  - Wait a second, there is no hurry
- How long to press the original button?
  - Press for 1 second first
  - If 1 second fails, press a shorter time.

# Learn - tool

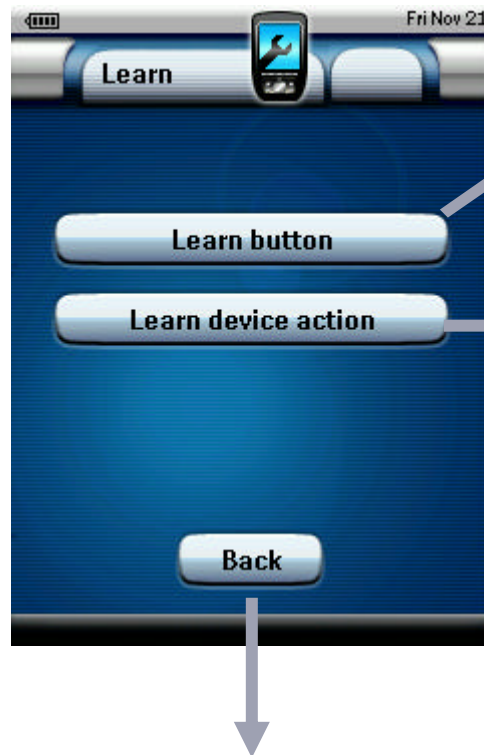

You can still navigate to all buttons. Press Exit when learning is done.

Opens device menu. You can not navigate to the device pages.

Note on the device action:

- You can not disable the device action execution
- You can not delete the device action
- To get rid of the device action you need to use ProntoProEdit NG

Go back to the tools menu

# Learn - tool - ctd

- The **first** time you press learn you will see:

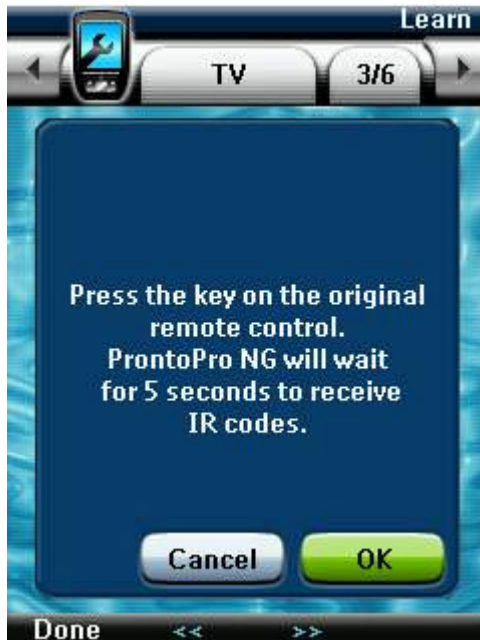

- You can not learn the cursor when in cursor navigation mode:
  - Switch of using  when you need to learn the cursor



# Learn - tool - ctd

- When pressing a button, the indication on top changes:



- When finished learning you need to press “done” this will bring you back to the tools menu



# PHI



Adapting / creating a macro

# Macro - tool

- Functions:
  - Adapt existing macros
  - Create new macros
- Usage:
  - Finetuning macros created on PC, when delays do not match or another code is needed
- Limitations:
  - You can only create links to buttons
  - Beeps are fixed
  - Delays can be adapted

# Macro - tool

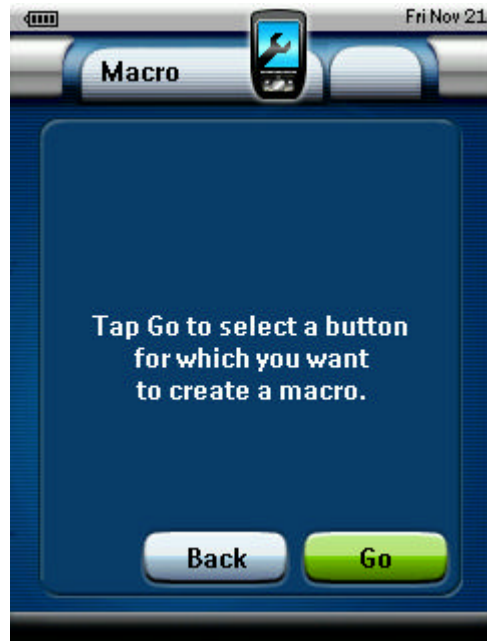

You can navigate to the correct button and select.

No indication which button is selected!



Moves the selected action in the list

Test the Macro, excluding jumps

Delete the selected action

# Macro – tool - ctd

- Add:
  - Allows you to add an IR code from another button (= makes a link). When pressing the current button, nothing happens
- Beep:
  - Will insert a standard beep
  - Parameters are not changeable
- Delay:
  - Will insert a delay of 0.5 seconds
  - To change select the delay and use the 2 middle LCD buttons

# PHI

## Other tools





# Label - tool

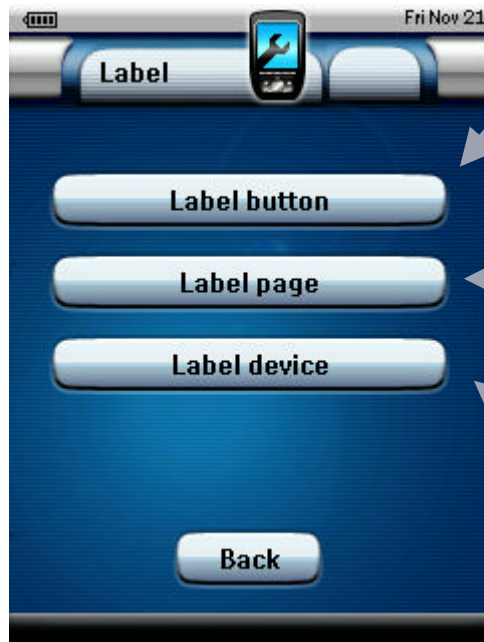

Will allow you to navigate to the button you want

Label pages of a device. Opens the page of the device you have currently open, but you can use the device menu to select another device

Will open the device menu

# Label - tool

- When labeling, a keyboard will appear, selecting a letter will popup an autozoom keyboard.

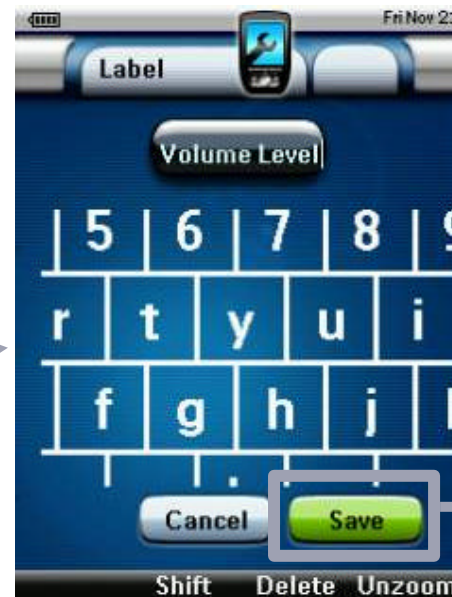
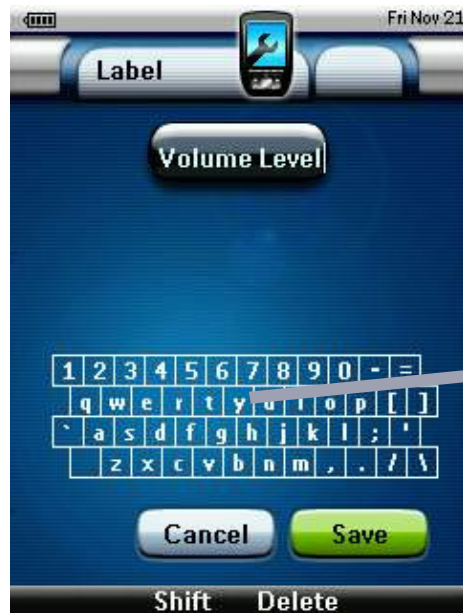

Store the label

Pressing the shift button, will popup different keyboards



# Delete - tool

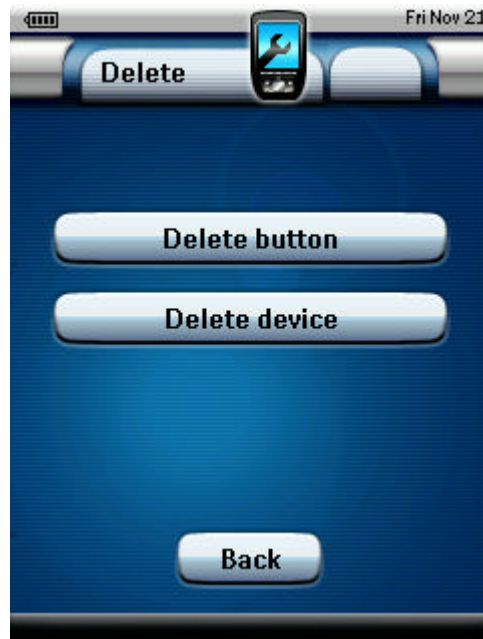

Undo the last action

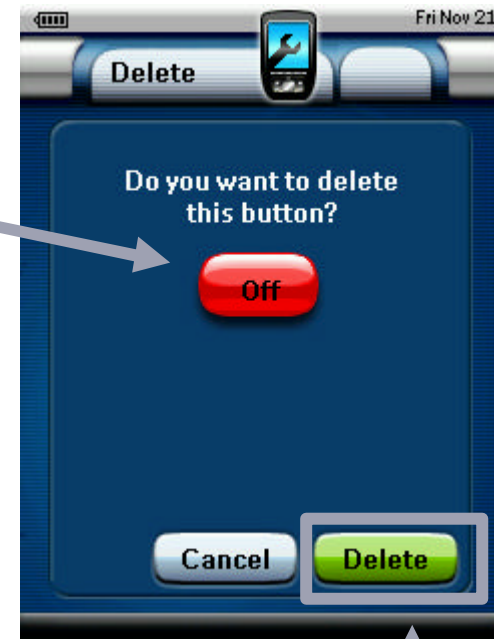

You need to press this button.

# Delete – tool - ctd



- Undo:
  - You can undo up to 15 delete actions
  - Only undoes actions that you performed while in this session of delete
- Deleting a button:
  - There is no way to restore the button
  - Delete is not deleting the action (like in the old pronto) it is removing forever. (Action can be deleted using macro)
- Deleting a device:
  - Device is **not** added in the ADD tool

# Timer – tool

- Timers:
  - Execute a link at a specified time and date
  - Are not stored in the pcf, so you can not set timers in the editor
  - They have a start action and a stop action
    - The actions are like a macro => same edit mode
  - They can repeat daily or weekly (with the selection of the days)
    - In case a repetition is defined, you can also define a stop date
  - Timers need to be activated before they will execute

# Timer – tool - ctd

- Icons used in timer mode

- Active timer 
- Inactive timer 
- Repeating timer 

Select to activate a timer.  
Note: the timer needs to have a start date and time in the future (even if the timer is repeated)





# Timer – tool - ctd



Repeat timer settings:  
selecting no, daily or  
every day of the week

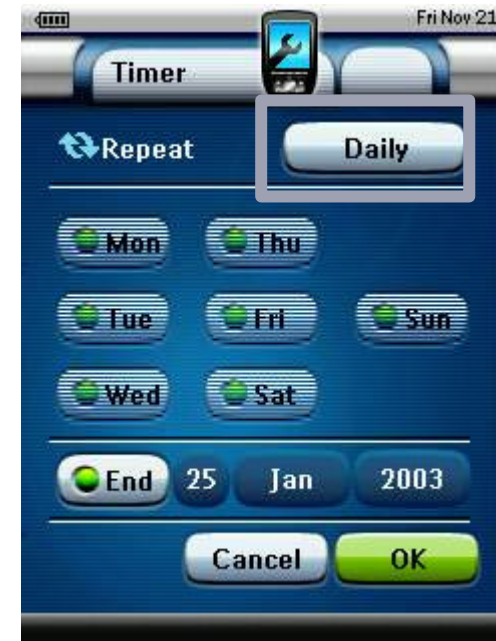

# Add - tool

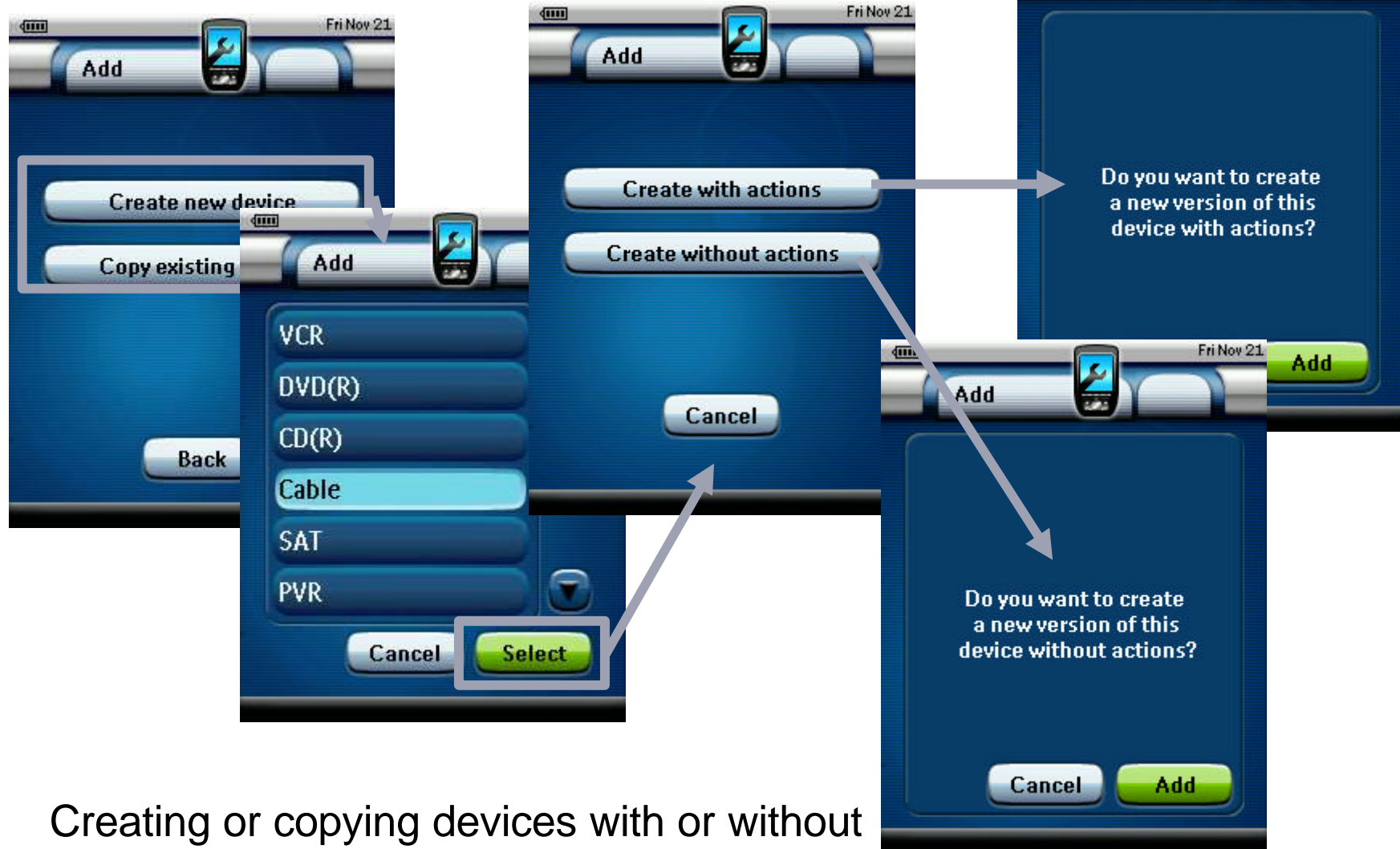

Creating or copying devices with or without actions



## Add – tool - ctd

- Create new device will make a default device:
  - If you need to reset a specific device to its default you need to delete the device and create a new device of the same type
  - Copy device will keep ALL settings of the device

# Move - tool

- Changes the order on the device overview and the order used for device navigation



Changes the order

